



GUELL ZERO

The **Guell Zero** is a modern weatherproof LED floodlight offering excellent beam control allowing the elimination of unwanted and intrusive spill light. The compact design is ideal for indoor applications as well.



IP66
IP44

IK 06
1.4J

Class I



LED



GUELL ZERO

Specification

- Body - die-cast aluminium body, pre-treated and powder coated (grey)
- Fixings - stainless steel lens cover clips and external screws
- Diffuser - permanently sealed tempered glass diffuser
- Fire resistant to 650°C
- Colour temp. - 4,000K
- Reflector - high purity and polished aluminium
- LED - high performance COB
- Beam type - wide asymmetrical/ medium symmetrical
- Driver - integral (ETRC)
- Installation - powder coated (grey) steel mounting bracket
- Electrical connection - complete with 1m of cable H07RN-F 3G1

Special Features

- High reliability and very low maintenance
- EMC compliant - product complies with all provisions set out in AS/NZS CISPR 15:2011

Accessories

- PIR sensor available on DETEK version
- Versions of Guell Zero Kit with 0.5m arm and integrated connection box are suitable for cascade connection

Applications

- Ideal for discreet installations where the luminaire needs to be concealed such as shops, facades, sculptures and architectural settings through to demanding applications such as sport gymnasiums, security and industrial locations.

Measurements & Weights

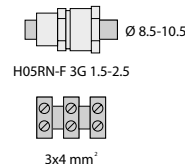
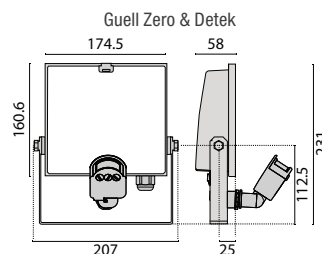
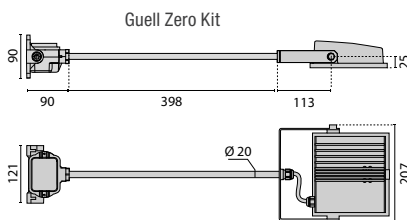

Guell Zero
Kit



2.5
MAX

Guell Zero



1.3
MAX

Technical Data

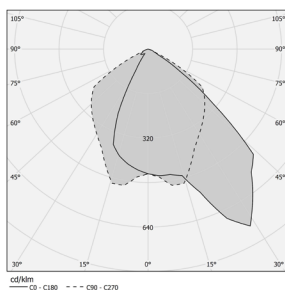

A40 15W LED 4K

LED Characteristics Explanation www.eyelighting.com.au/led-characteristics

Product Type	Colour Temp (K)	Rated Av. Life (L70)	Lumen Output (lm)	R/Rx	Efficacy (lm/W)
15W - Asym. Wide	4,000	150,000	855	Rx	57
9W - Asym. Wide	4,000	150,000	635	Rx	70
15W - Sym. Medium	4,000	150,000	996	Rx	66

Product Range

Guell Zero A/W

	Code	Description	Output ℓm	LED	Driver	Distribution
LED	173300	ELI Guell Zero A/W LED 9W 840	635	9W LED	Integral	Asymmetrical wide beam
	173305	ELI GUELL ZERO A/W LED 15W 840	855	15W LED	Integral	Asymmetrical wide beam

Guell Zero DETEK

	Code	Description	Output ℓm	LED	Driver	Distribution
LED	173325	ELI Guell Zero Detek A/W LED 15W 840 IP44	855	15W LED	Integral	Asymmetrical Wide Beam

Guell Zero Kit

	Code	Description	Output ℓm	LED	Driver	Distribution
LED	173340	ELI Guell Zero Kit S/W LED 15W 840	996	15W LED	Integral	Symmetrical Medium Beam

Pictorial is representative only. Specifications may change without notice.





GUELL 1

The **Guell 1** is a modern weatherproof LED floodlight delivering excellent asymmetrical beam control eliminating unwanted and intrusive spill light. It is ideal for a range of diverse and demanding applications.



IP66
IP44

IK 07
3J

Class I



LED



GUELL 1

Specification

- Body - die-cast aluminium body, pre-treated and powder coated (grey)
- Fixings - anodised aluminium cover clips with stainless steel springs
- Lens - flat tempered glass diffuser
- Fire resistant to 650°C
- Colour temp. - 4,000K
- Reflector - high purity iridescence-free aluminium reflector (Imax 40°) oxidised and polished
- LED - high performance COB
- Beam type - wide asymmetrical
- Driver - integral (ETRC)
- Installation - powder coated (grey) steel bracket
- Electrical connection - M20x1.5 cable gland for Ø10-14mm cable

Special Features

- High reliability and very low maintenance
- EMC compliant - product complies with all provisions set out in AS/NZS CISPR 15:2011

Accessories

- PIR sensor available on special request

Applications

- Ideal for discreet installations where the luminaire needs to be concealed such as shops, facades, sculptures and architectural settings through to demanding applications such as sport gymnasiums, security and industrial locations.

Measurements & Weights

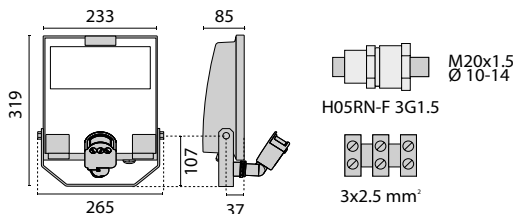

2.4
MAX

Technical Data

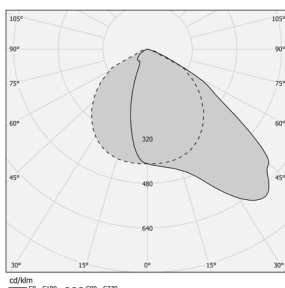

A40 60W LED 4K

LED Characteristics Explanation www.eyelighting.com.au/led-characteristics

Product Type	Colour Temp (K)	Rated Av. Life (L70)	Lumen Output (lm)	R/Rx	Efficacy (lm/W)
26W LED	4,000	150,000	2319	Rx	89
39W LED	4,000	150,000	3522	Rx	90
58W LED	4,000	150,000	4544	Rx	78

Product Range

Accessories

Guell 1 A/W

	Code	Description	Output lm	LED	Driver	Distribution
LED	173000	ELI Guell 1 A/W LED 26W 840	2319	26W LED	Integral	Asymmetrical Wide Beam
	173005	ELI Guell 1 A/W LED 39.5W 840	3522	39W LED	Integral	Asymmetrical Wide Beam
	173010	ELI Guell 1 A/W LED 57.5W 840	4544	58W LED	Integral	Asymmetrical Wide Beam

Code	Description
173080	Wire guard galvanised steel (A0650)
173082	Internal raster for Guell 1 Asymmetrical (A0652)

Guell 1 DETEK

	Code	Description	Output lm	LED	Driver	Distribution
LED	173060	ELI Guell 1 Detek A/W LED 58W 840 IP44	4544	58W LED	Integral	Asymmetrical Wide Beam

Pictorial is representative only. Specifications may change without notice.



GUELL 2

The **Guell 2** is a powerful weatherproof LED floodlight offering excellent beam control allowing the elimination of unwanted and intrusive spill light. The compact design is ideal for a wide range of diverse and demanding applications.



IP66

IK 07
3J

Class I



LED



GUELL 2

Specification

- Body - die-cast aluminium body, pre-treated and powder coated (grey)
- Fixings - anodised aluminium cover clips with stainless steel springs
- Lens - flat tempered glass diffuser
- Fire resistant to 650°C
- Colour temp. - 4,000K
- Reflector - high purity iridescence-free aluminium reflector (Imax 40°) oxidised and polished
- LED - high performance COB
- Beam type - wide asymmetrical
- Driver - integral (ETRC)
- Installation - powder coated (grey) steel bracket
- Electrical connection - M20x1.5 cable gland for Ø10-14mm cable

Special Features

- High reliability and very low maintenance
- EMC compliant - product complies with all provisions set out in AS/NZS CISPR 15:2011

Accessories

- Dimmable ballast available on special request

Applications

- Ideal for discreet installations where the luminaire needs to be concealed such as shops, facades, sculptures and architectural settings through to demanding applications such as sport gymnasiums, security and industrial locations.

Measurements & Weights

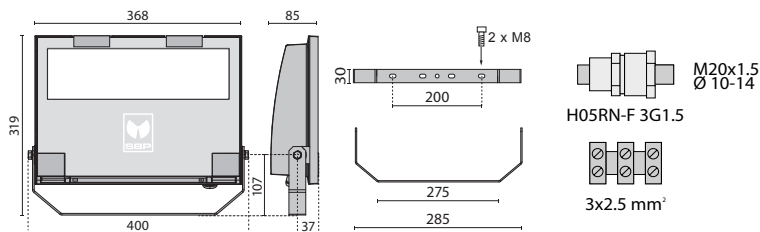

3.6
MAX

Technical Data

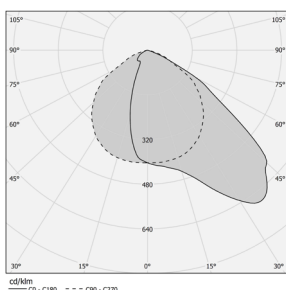

A40 120W LED 4K

LED Characteristics Explanation www.eyelighting.com.au/led-characteristics

Product Type	Colour Temp (K)	Rated Av. Life (L70)	Lumen Output (lm)	R/Rx	Efficacy (lm/W)
78W LED	4,000	150,000	7224	Rx	92
114W LED	4,000	130,000	8934	Rx	78

Product Range

Accessories

	Code	Description	Output lm	LED	Driver	Distribution
LED	173100	ELI Guell 2 A/W LED 78.5W 840	7,224	78.5W LED	Integral	Asymmetrical wide beam
	173105	ELI Guell 2 A/W LED 114W 840	8,934	114W LED	Integral	Asymmetrical wide beam

Pictorial is representative only. Specifications may change without notice.

Code	Description
173180	ELI Guell 2 A/W cover (A0656)
173181	ELI Guell 2 galvanised steel wire guard (A0655)
173182	ELI Guell 2 S/W internal raster (A0657)
173183	ELI Guell 2 A/W internal raster (A0658)
173184	ELI Guell 2 single pole top bracket (A0660/1)
173185	ELI Guell 2 double pole top bracket (A0660/2)



GUELL 3

The **Guell 3** is a powerful weatherproof LED floodlight delivering excellent asymmetrical beam control eliminating unwanted and intrusive spill light. It is ideal for applications requiring high light levels such as large outdoor areas.



IP66

IK07
3J

Class I



LED



GUELL 3

Specification

- Body - die-cast aluminium body, pre-treated and powder coated (grey)
- Fixings - anodised aluminium cover clips with stainless steel springs
- Diffuser - flat tempered glass diffuser
- Fire resistant to 650°C
- Colour temp. - 4,000K
- Reflector - high purity and polished aluminium reflector
- Beam type - wide asymmetrical
- Driver - integral (ETRC)
- Installation - powder coated (grey) steel mounting bracket
- Electrical connection - cable gland M20x1.5 for cables Ø 10 - 14 mm

Special Features

- 1-10V dimmable ballast available
- High reliability and very low maintenance
- EMC compliant - product complies with all provisions set out in AS/NZS CISPR 15:2011

Applications

- Ideal for installations requiring a high powered floodlight such as large open areas through to demanding applications such as sport gymnasiums, security and industrial locations.

Measurements & Weights

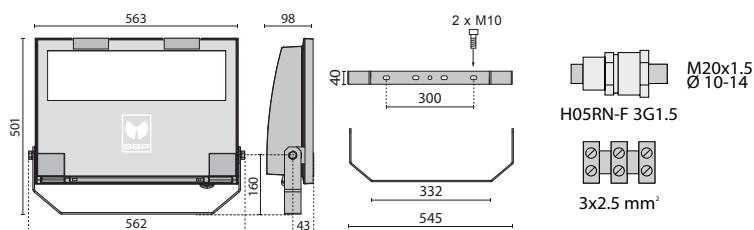

12
MAX

Technical Data

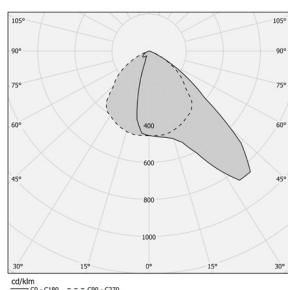

A40 334W LED 4K

LED Characteristics Explanation www.eyelighting.com.au/led-characteristics

Product Type	Colour Temp (K)	Rated Av. Life (L70)	Lumen Output (lm)	R/Rx	Efficacy (lm/W)
293W LED	4,000	130,000	21521	Rx	73
334W Dimmable (1-10V)	4,000	130,000	22897	Rx	Up to 68

Product Range

Accessories

Guell 3 A/W

	Code	Description	Output lm	LED	Driver	Distribution
LED	173200	ELI Guell 3 A/W LED 212W 840	16,720	212W LED	Integral	Asymmetrical Wide Beam
	173205	ELI GUELL 3 A/W LED 293W 840	21,521	293W LED	Integral	Asymmetrical Wide Beam

Code	Description
173290	Wire guard galvanised steel (A0665)

Guell 3 Dimmable (1-10V)

	Code	Description	Output lm	LED	Driver	Distribution
LED	173210	ELI Guell 3 A/W DIM LED 166W 840	12,414	166W LED	Integral	Asymmetrical Wide Beam
	173215	ELI Guell 3 A/W DIM LED 252W 840	18,490	252W LED	Integral	Asymmetrical Wide Beam
	173220	ELI Guell 3 A/W DIM LED 334W 840	22,897	334W LED	Integral	Asymmetrical Wide Beam

Pictorial is representative only. Specifications may change without notice.