



# PERFORMANCE LIGHTING



AQUA LED



## AQUA LED

AQUA is a range of Class III LED underwater spotlights designed to light up fountains and swimming pools. Aqua only functions when fully immersed in fresh water. The collection includes:

- AQUA LED and AQUA LED R, with LED 8 W, white colour, 6500 K nominal or 10 W RGB. Available with stainless steel bracket to be installed at the bottom of fountains or with recessed fixing kit for wall mounting (AQUA LED /R).
- AQUA MAXI, with LED 30 W, white colour, 6500 K nominal or RGB. Available with recessed fixing kit for wall mounting.





AQUA LED



AQUA LED /R



AQUA LED MAXI



# AQUA LED

Class III LED underwater spotlights designed to light up fountains and swimming-pools, includes:

- black technopolymer body
- PMMA diffuser sealed to the body with dedicated resins to form a single inseparable body
- AISI 316 stainless steel bracket (only for AQUA version) to install the spotlight at the bottom of fountains
- technopolymer recessed fixing kit for wall mounting (only for AQUA/R version) with aesthetic base plate, distribution box, gaskets, connection tube and stainless steel screws, suitable for sinking into the cement of tiled swimming pools or of swimming pools lined with steel panels and liner
- LED light source, white colour, 6500 K, 8 W overall wattage or RGB 10 W
- complete with 3 meters of H07RN8-F 2x1.5 mm<sup>2</sup> cable
- 12 V AC power supply with safety transformers available as accessories
- stainless steel external screws.



lampholder	W	class	IP	optic	wiring	∇	Kelvin	↕	Cos φ ≥ 0,9	EEL	cod	Notes
------------	---	-------	----	-------	--------	---	--------	---	----------------	-----	-----	-------

## AQUA LED

n 3 LED	8 W	III	68 (3m)	C/EW			6500				<b>06085720</b>	
n 3 LED	10 W	III	68 (3m)	C/EW							<b>06085820</b>	

Luminaire supplied complete with 3 meters of H07RN8-F 2x1.5 mm<sup>2</sup> cable.

lampholder	W	class	IP	optic	wiring	∇	Kelvin	↕	Cos φ ≥ 0,9	EEL	cod	Notes
------------	---	-------	----	-------	--------	---	--------	---	----------------	-----	-----	-------

## AQUA LED / R

n 3 LED	8 W	III	68 (3m)	C/EW			6500				<b>06085920</b>	
n 3 LED	10 W	III	68 (3m)	C/EW							<b>06086020</b>	

Luminaire supplied complete with 3 meters of H07RN8-F 2x1.5 mm<sup>2</sup> cable.



Code	Denomination	Description
<b>14168304</b>	A0645	Stainless steel aesthetic ring for AQUA/R
<b>14168420</b>	A0646	Control unit designed for simultaneous management of colour change for AQUA LED RGB and AQUA LED / R RGB. Complete with technopolymer IP56 Box, additional antenna connection and remote control. Preset with display lighting scenes to be selected with the remote control. 12 V AC power supply with safety transformers. The maximum number of controllable luminaires depends on power supply transformer wattage up to a maximum load of 300 W.
<b>14168520</b>	A0647	Kit includes antenna + 5 meters of cable to link up to the Control Unit for RGB. Allows to conceal the RGB Control Unit ensuring excellent reception of signals issued by the remote control.
<b>14423998</b>	A0127/T	100 VA safety transformer to be installed in an area protected from humidity and rain.

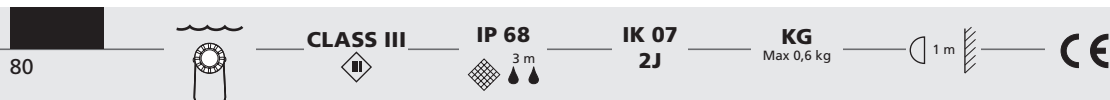

## AQUA LED

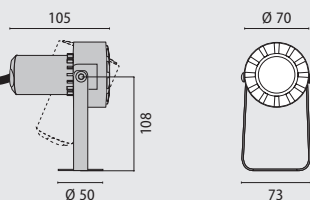



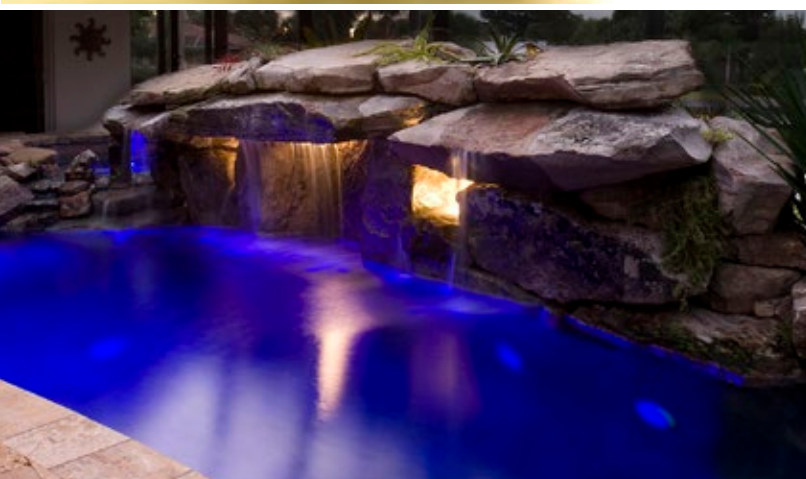

87



CLASS III



IP 68



IK 07

2J

KG

Max 0,4 kg



1 m



AQUA/R LED

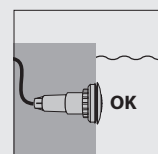
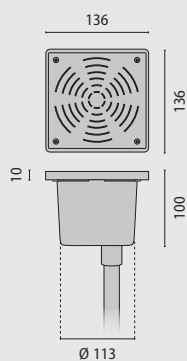
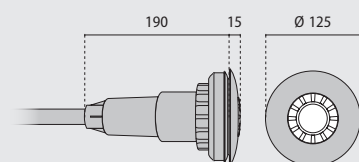

# AQUA LED MAXI

- Class III LED underwater spotlights designed to light up fountains and swimming-pools, includes:
- technopolymer body
  - polycarbonate light source body
  - polycarbonate diffuser
  - technopolymer recessed fixing kit for wall mounting with aesthetic base plate, distribution box, gaskets, connection tube and stainless steel screws; suitable for sinking into the cement of tiled swimming pools or of swimming pools lined with steel panels and liner
  - LED light source, white colour, 6500 K or RGB, max absorption 30 W
  - stainless steel springs to fix the luminaire body to the fixing kit
  - complete with 3 meters of H07RN8-F 2x6 mm<sup>2</sup> cable
  - 12 V AC power supply with safety transformers available as accessories
  - stainless steel external screws.



lampholder	W	class	IP	optic	wiring	▽	Kelvin	↕	Cos φ ≥ 0,9	EEL	cod	Notes
<b>AQUA LED MAXI /R</b>												
n 9 LED	30 W	III	68 (3 m)	C/EW			6500				<b>06086120</b>	🔌
n 9 LED	30 W	III	68 (3 m)	C/EW			🌈				<b>06086220</b>	🔌

🔌 Luminaire supplied complete with 3 meters of H07RN8-F 2x6 mm<sup>2</sup> cable.



Code	Denomination	Description
<b>14168420</b>	A0646	Control unit designed for simultaneous management of colour change for AQUA LED MAXI RGB. Complete with technopolymer IP56 Box, additional antenna connection and remote control. Preset with display lighting scenes to be selected with the remote control. 12 V AC power supply with safety transformers. The maximum number of controllable luminaires depends on power supply transformer wattage up to a maximum load of 300 W.
<b>14168520</b>	A0647	Kit includes antenna + 5 meters of cable to link up to the Control Unit for RGB. Allows to conceal the RGB Control Unit ensuring excellent reception of signals issued by the remote control.
<b>14423998</b>	A0127/T	100 VA safety transformer to be installed in an area protected from humidity and rain.
<b>14094920</b>	A0128/T	350 VA safety transformer to be installed in an area protected from humidity and rain.

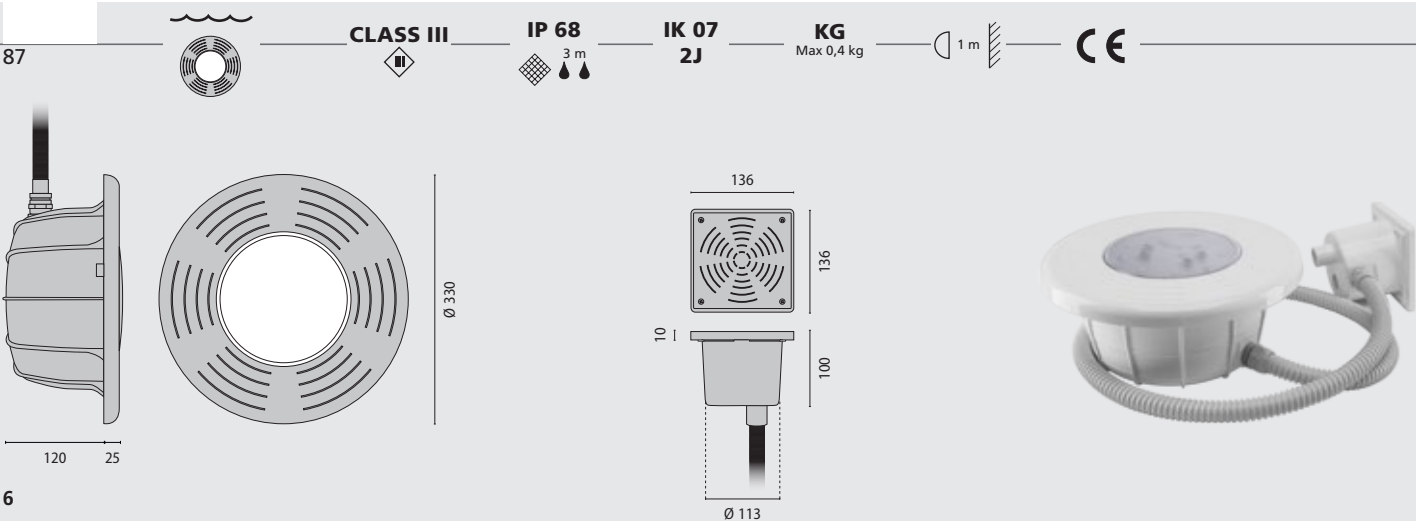



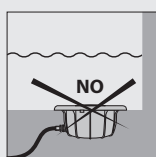
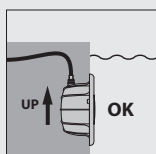

**SBP URBAN LIGHTING®** is a brand of  
**PERFORMANCE IN LIGHTING s.p.a.**  
via Provinciale, 57 - 24050 Ghisalba (BG) - Italia  
info@sbp-pil.com

**EXPORT DEPARTMENT**

**P** +39 0363 94 06 22  
**F** +39 0363 94 06 99  
euroexport@sbp-pil.com  
worldexport@sbp-pil.com

**Performance in Lighting (Australasia)**

**HEAD OFFICE & DESIGN CENTRE**

157 Wellington Road  
East Brisbane QLD 4169  
Australia

**P** 1800 635 383  
**E** info@performanceinlighting.com.au  
**www.performanceinlighting.com**

**Australia (Queensland)**

15 Industrial Avenue  
Wacol QLD 4076  
Australia

**P** +61 (0) 7 3335 3588  
**F** +61 (0) 7 3335 3533  
**E** info@eli.com.au

**New South Wales**

18-30 Salisbury Street  
Silverwater NSW 2128  
Australia

**P** +61 (0) 2 9648 5611  
**F** +61 (0) 2 9748 6839  
**E** info@eli.com.au

**Victoria**

7-9 Melrose Court  
Tullamarine VIC 3043  
Australia

**P** +61 (0) 3 9335 2188  
**F** +61 (0) 3 9330 0130  
**E** info@eli.com.au

**South Australia**

32A Croydon Street  
Keswick SA 5035  
Australia

**P** +61 (0) 8 8297 5155  
**F** +61 (0) 8 8297 5030  
**E** info@eli.com.au

**New Zealand (North Island)**

18 Levene Place  
Mt Wellington Auckland  
New Zealand

**P** +64 (0) 9 276 8099  
**F** +64 (0) 9 276 3437  
**E** sales@elnz.co.nz

**Western Australia**

8 Gould Street  
Herdsman Business Park Osborne Park  
WA 6017  
Australia

**P** +61 (0) 7 3335 3575  
**F** +61 (0) 7 3335 3544  
**E** info@eli.com.au

**North Queensland**

Ralph Buck Agencies, 15 Mackley Street  
Garbutt QLD 4814  
Australia

**P** +61 (0) 7 4779 0177  
**F** +61 (0) 7 4775 1480  
**E** info@eli.com.au

**New Zealand - Lower North  
Island/ South Island**

**P** +64 (0) 21 967 100  
**E** sales@elnz.co.nz